

COLOR DOME CAMERA

HDC-325,425NA/PA -ITEM1,ITEM2

Thank you for choosing Honeywell Dome camera.
Please read these instructions carefully before operating this unit, and retain this manual for future reference.
If you have any problems with this camera, contact your local supplier to service.

1. Specifications

ITEM	Specifications			
Model No.	HDC-325NA	HDC-325PA	HDC-425NA	HDC-425PA
Imaging Device	1/3" Interline Transfer CCD			
TV System	NTSC	PAL	NTSC	PAL
Total pixel	270,000 pixel	320,000 pixel	410,000 pixel	470,000 pixel
Effective Pixel	250,000 pixel	290,000 pixel	380,000 pixel	440,000 pixel
Scanning System	2:1 Interlace			
Horizontal Resolution	330 TVL	320 TVL	480 TVL	470 TVL
S/N Ratio	More than 48 dB			
Min. Illumination	0.1 lx (AGC ON)		0.5 lx (AGC ON)	
Gamma	0.45			
Video Output	1.0Vp-p / 75Ω			
Electronic Iris	1/60 ~ 1/100,000 sec			
Basic Lens (ITEM1)	3.8mm / F2.0 (ITEM :38), 6.0mm/F2.0 (ITEM:60)			
Body Color (ITEM2)	"B"; BLACK, "G"; GRAY			
Power Source	DC12V ± 2.0V			
Power Consumption	Less than 130mA		Less than 180mA	
Operating Temperature	-10°C ~ 50°C			
Storage Temperature	-20°C ~ 60°C			
Operating Humidity	90% RH Max.			
Weight	197g			
Dimension	100 (φ) × 84 (h) mm			

2. Select switch description

FLS		OFF
HOLD		AWB
AGC		OFF
OFF		BLC
DC		ELC

HDC-325NA/PA : SW901A
HDC-425NA/PA : SW1HA

<Slide switch SW901A, SW1HA>

FLS/OFF : Flickerless ON, OFF
AWB/HOLD : White Balance AUTO, HOLD
AGC/ON : Auto max gain control ON, OFF
(ON : Increase dark noise level)
BLC/OFF : Backlight compensation ON, OFF
ELC/DC : Electronic Light Control lens/ DC Iris lens
***Level (VR1A)** : Sensitivity control for DC Iris lens

3. How to install

3.1 Connections

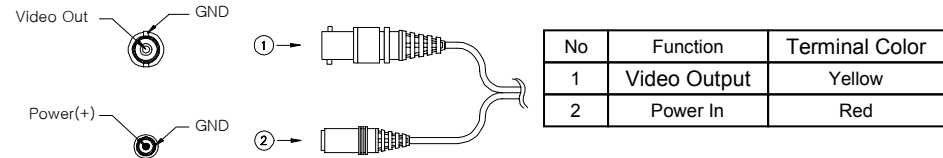

3.2 Installation and Adjustment



1. Remove the dome cover by turning it to the right in pushing spring down.
2. Open the lens cover.
3. Disjoint screw for inner fixing cover.
4. After disjoint an inner cover, open lens cover.

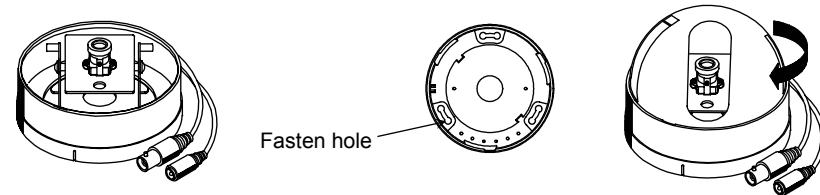

5. Fasten dome base on the ceiling.
6. Adjust up and down angle by screw
7. Adjust desired focus, fix it.
8. After cover an inner, fixing the cover by screw.
9. Attach dome cover to case and assemble by turning to the left.
(Set window of dome cover toward camera lens.)

* Please keep dome cover and camera lens clean for better picture.

Honeywell

Office : 18F, Hanil Group Building 191
Hangangro-2ga, Yongsan-gu,
Seoul 140-702, Korea
Phone : 82-2 - 799 - 6202
Fax : 82-502 - 749 - 6119
Http://www.honeywell.co.kr/cctv